



YOYO**Cam**™

QUICK START GUIDE
YOYO**Cam** G2
GSM Remote Surveillance Camera



www.yoyomotion.com

YOYOCam G2 Features

Insert a SIM card, perform a few simple configuration steps and YOYOCam is ready to guard your property.

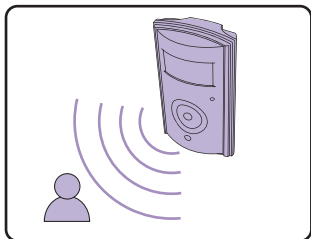

Infrared body detector and camera-based movement detection

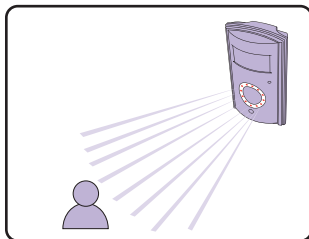

Infrared LEDs enable the camera to capture images in the dark

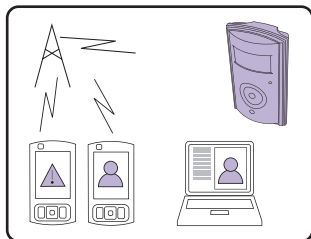

Alarm by SMS (text), MMS and Email (including images)

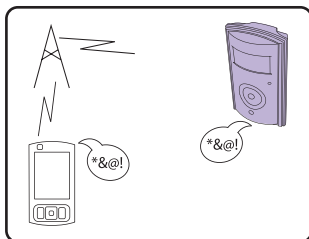

Dial YOYOCam and listen in

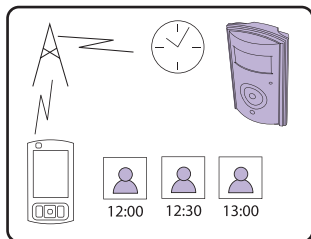

Receive images at pre-set intervals according to a schedule

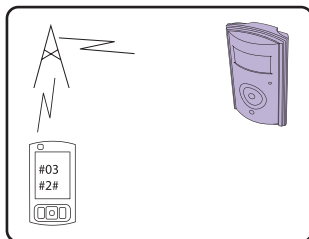

Simple configuration via SMS commands; request images by SMS

Get to know YOYOCam G2

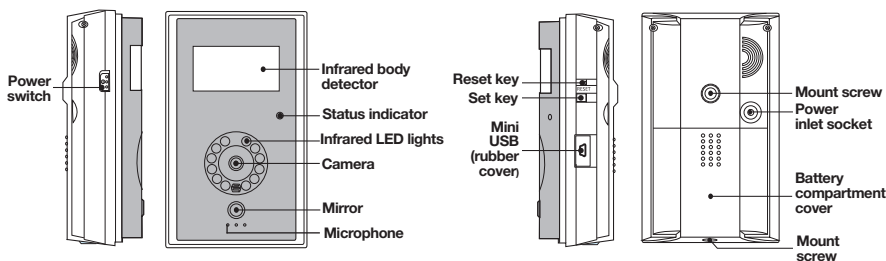

STEP 1. Prepare YOYOCam G2

1. Slide the battery compartment cover downwards.
2. Lift the battery cover away from the device.
 - **WARNING:** Always be sure to switch off YOYOCam and disconnect the power before inserting or removing the SIM card. Do not touch the gold contacts of the SIM Card.
 - **NOTE:** The SIM PIN must be disabled. Use an ordinary mobile phone to check and, if necessary, turn off SIM Lock.
3. Hold the SIM card in line with the slot (gold contacts on the underside) and slide it in to position.
4. Replace the battery compartment cover

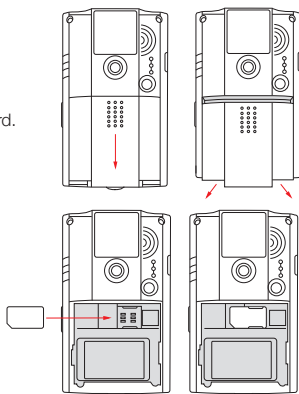

STEP 2. Mount YOYOCam G2

1. Mount the bracket on the wall, ceiling or other surface as required.
2. Attach YOYOCam to the threaded tip of the bracket.
3. Screw the round lock-nut towards YOYOCam to secure YOYOCam on the mount.
4. Loosen the screw so that the angle can be adjusted.
5. Tighten the screw to fix YOYOCam in the desired position.

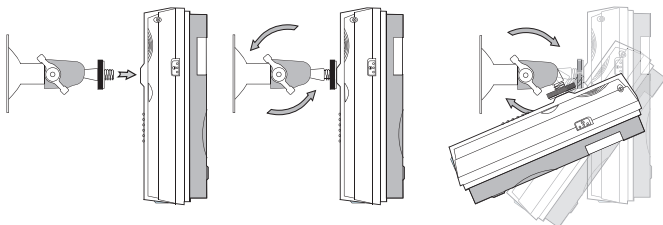

Note: There is a second mount position on the underside of YOYOCam. The mount screw-threads are standard photographic size, so YOYOCam can, for example, be mounted on a camera tripod.

Note: For best results, avoid pointing YOYOCam at bright lights or windows. See the User Guide for more tips.

STEP 3. Set Up YOYOCam G2

1. Connect the cable from the power adaptor to the power inlet socket on the back panel, as shown.
2. Plug the power adaptor in to a wall outlet or socket strip.
3. Slide the power switch to the UP position to turn on YOYOCam
4. After approximately 40 seconds, YOYOCam bleeps to indicate that the GSM network has been found.
5. From your mobile phone, send an SMS with text #00# to YOYOCam. YOYOCam confirms your phone as Master by SMS, meaning that you have full control over YOYOCam.
6. The SMS responses are in Swedish by default. Send #127#1# to switch to English.
7. Network MMS settings are configured automatically for the major networks. If your network operator is in the table to the right, you must now send the command indicated in order to configure MMS.
8. Arm YOYOCam
 - Send an SMS with text #01# to arm YOYOCam
 - Send an SMS with text #02# to disarm YOYOCam

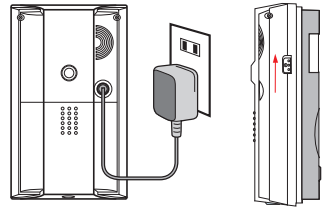

Network Operator	Command to send
ACN	#145#ACN#
Cell Mobile SE	#145#CELLMOBILE#
Chess NO	#145#CHESSNO#
Glocalnet	#145#GLOCALNET#
Halebop	#145#HALEBOP#
Parlino	#145#PARLINO#
Superstar	#145#SUPERSTAR#
TDC Song NO	#145#TDCNO#
TDC Song SE	#145#TDCSE#
Telmore DK	#145#TELMORE#
Universal	#145#UNIVERSAL#
Ventelo NO	#145#VENTELONO#
Ventelo SE	#145#VENTELOSE#

YOYOCam is now operational.

When armed, YOYOCam will raise the alarm when a sensor detects an event. By default, the built-in infrared body sensor is enabled and camera movement detection is disabled. When the alarm is raised, YOYOCam sends an SMS to the Master followed by an MMS with images. Other options include voice call and E-Mail alarms. Detector, image and alarm settings can be configured – see *Using YOYOCam G2* and the full User Guide.

YOYOCam G2 Status Indicator

LED Status

- Searching for network / SIM PIN enabled
- Alarm triggered
- No SIM card / System error
- Loading wireless remote sensor
- Armed
- Disarmed / Waiting for Master number
- Sending messages / Ongoing voice call
- Factory reset / Loading sensor.

Key

- Fast flash (two flashes per second)
- Slow flash (one flash per second)
- Two second flash

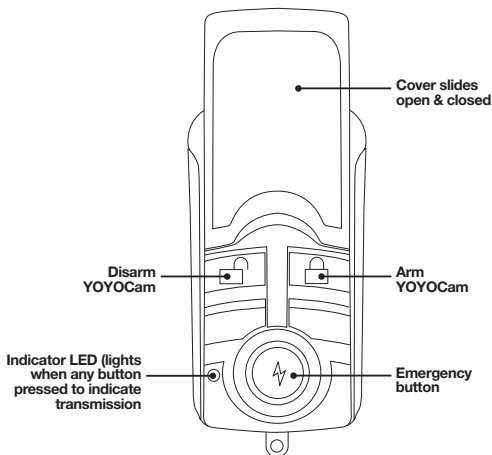

Note: Send #143#0# to disable LED, #143#1# to enable it (default).

Remote Control



Press  to arm YOYO Cam.

Press  to disarm YOYO Cam.

When the Emergency button  is pressed, YOYO Cam acknowledges with a bleep. By default, YOYO Cam calls the Master and each added Emergency number in turn until someone answers, at which point that person can hear the audio from YOYO Cam. YOYO Cam tries each number up to three times before giving up. The LED indicator displays  ongoing voice call.



Note: If YOYO Cam is set to call a landline, check that hanging up the landline clears the call; some telephone networks do not clear the call when the called end hangs up, making it impossible to dial a new call. We recommend that emergency calls are made to mobile numbers.

Alternatively, send #39#1# to YOYO Cam to set SMS/MMS mode. When the Emergency button is pressed YOYO Cam acknowledges with a bleep, and sends an SMS alert followed by an MMS with an image to the Master and each added Emergency number.

Note: YOYO Cam responds to the Emergency button in both Armed and Unarmed states. If YOYO Cam is busy, for example sending images, the ongoing operation is cancelled in order to action the Emergency alarm.

Pairing your YOYO Cam with a Remote Control

Before use, each remote must be paired with your YOYO Cam. Up to five remotes can be paired; two are supplied.

1. Press the SET button. YOYO Cam bleeps and LED flashes orange  indicating pairing mode.
2. Press any button on the remote control. YOYO Cam bleeps and LED turns green  for 2 seconds then returns to orange flashing  ready to pair another remote control.
3. Press SET to exit pairing mode. In any case pairing mode times out after 15 seconds.

Using YOYOcam G2

Users interact with YOYOcam using SMS commands and voice calls. There are three levels of access – MASTER, USER & GUEST:

MASTER

There is one Master user who has complete control over YOYOcam. Master-only commands:

Text to send	What it does
#00#	(after factory reset) sender becomes Master
#14#NewMasterNumber#	Change from present Master number to NewMasterNumber
#04#OldPassword#NewPassword#	Change the Guest password (default is 1234)
#06#UserNumber#	Add a User.
#113#UserNumber#	Delete a User
#106#EmergencyNumber#	Add Emergency Number (called when emergency button pressed on remote)
#107#EmergencyNumber#	Delete Emergency Number
#127#LanguageCode#	Set Language. 0=Swedish (default); 1 = English

For example, send #04#1234#6789# to change password to 6789. Send #06#0702222222# to add 0702222222 as a user.

MASTER & USER

Up to 10 Users set up by the Master can access YOYOcam. Master and Users can send these commands:

Text to send	What it does
#01#	Arm YOYOcam (if an event is detected, alarm is triggered)
#02#	Disarm YOYOcam (events will be ignored)
#03#	Take one image and send it to the requesting user
#03#Quantity#	Take a number (Quantity 1-8) of images and send to requestor
#07#	Check the settings and status
#09# or #09#1#	Get the command list (#09# for SMS, #09#1# for MMS response)
#32#Size#	Set image size: 1: 160x128; 2: 320x240 (default); 3: 640x480
#33#Quantity#	Set quantity of images to take when triggered: 1-8 (default 3; note 1)
#118#0# or #118#1#	Disable (0) infrared body detection; enable (1) (default)
#22#0# or #22#1#	Disable (0) camera based motion detection (default); enable (1)
#39#0#	Call mode – When Emergency button pressed, numbers are dialed
#39#1#	SMS/MMS mode – when Emergency button is pressed, YOYOcam sends SMS and MMS.
#143#0# or #143#1#	Disable (0) indicator LED; enable (1) (default)

Master & Users can also call YOYOcam and listen in via the built-in microphone.

GUEST

Guest users are people who do not normally need access, but might be asked to check the protected area because they are nearby, for example. Guest users do not need to be pre-defined to YOYOcam, but do require the PIN.

Guest commands:

Text to send	What it does
#03#Password#	Take one image and send it to the requesting guest
#03#Password#Quantity#	Take a number (Quantity 1-8) of images (note 1)
#30#Password#To#Quantity#	Take a number (Quantity 1-8) of images and send to a phone or E-mail address (To is the mobile number or E-Mail address; note 1)

Note 1: Maximum Quantity is limited to 2 when image size is set to 3.

Download the User Guide & do more with YOYOCam G2



For more information, download the full user guide from www.yoyomotion.com/camera.html and you can also find out how to:

- Set an automatic arm/disarm schedule based on day and time.
- Set YOYOCam to automatically take and send images according to a day and time schedule.
- Add up to 15 remote sensors such as door magnets, smoke detectors etc.
- Change advanced settings including image brightness, orientation, alarm notification method, MMS parameters.

Factory Reset

If the Master phone is lost or you want to set up YOYOCam again from the beginning, you can use Factory Reset to set all settings and parameters back to the factory default. Following Factory Reset you will need to re-pair the remote controls and any remote sensors, re-enter any mobile network (MMS) settings and reconfigure all users etc.

To perform Factory Reset:

1. Switch Off YOYOCam and wait at least 20 seconds.
2. Press and hold the Reset key.
3. Switch on YOYOCam while the Reset key is still pressed.
4. After approx. 10 seconds, YOYOCam beeps and the indicator LED goes green  and then flashes red .
5. You may now release the Reset key.

Important Information

Please read this information before using your YOYOcam.

Safety and Usage Guidelines

- When inserting or removing the SIM card, do not touch the gold connectors.
- Use only the approved YOYOMotion AC power adaptor.
- Treat your YOYOcam carefully; store it safely and do not drop or throw it.
- Do not expose your YOYOcam to dust, liquid, moisture or humidity.
- Do not use or store your YOYOcam at extreme high or low temperatures.
- Do not expose your YOYOcam to naked flames, lit tobacco products or other heat sources.
- Do not use your YOYOcam in hospitals or near medical equipment.
- If you have personal medical devices such as a pacemaker, consult your physician and the manufacturer for advice.
- Do not use your YOYOcam in aircraft or in any place where use of radio transmitters is prohibited.
- Do not use your YOYOcam in places where a potentially explosive atmosphere is present.
- Do not use YOYOcam in proximity to car airbags.
- Do not attempt to take your YOYOcam apart; there are no user-serviceable components inside the product.
- Do not allow children to play with your YOYOcam; small parts such as SIM cards could be detached and represent a choking hazard.
- For optimum performance do not cover your YOYOcam; position it with good access to the mobile signal.
- You should not rely on any voice call capability that your YOYOcam provides for emergency or essential communications.

Battery

- Battery performance (device runtime) depends on signal strength, temperature, usage pattern and other factors.
- The battery may have temporarily reduced capacity when new or after a prolonged period without use.
- Turn of the device and disconnect the power adaptor before removing or inserting the battery.
- Do not allow the battery contacts to touch any metal object.
- Use only the supplied battery or accessory/service replacement battery from YOYOMotion

Disposal and Recycling

- Do not dispose of your YOYOcam with normal household waste.
- Dispose of your YOYOcam at an appropriate collection point for electronic equipment.
- For more information, contact your local authority, your household waste collection depot or the retailer where you bought your YOYOcam.

EU Regulatory Conformance

English: We fulfil the requirements of the R&TTE Directive (99/5/EC). **Český:** Výrobek splňuje požadavky směrnice R&TTE (99/5/EC). **Dansk:** Vi opfylder kravene i R&TTE-direktivet (99/5/EC). **Deutsch:** Die Anforderungen der Richtlinie für Funk- und Fernmeldegeräte (99/5/EG) werden erfüllt. **Español:** Cumplimos los requisitos de la Directiva R&TTE (99/5/EC). **Français:** Ce produit est conforme à la directive R&TTE (99/5/EC). **Hrvatski:** Mi ispunjavamo zahtjeve R&TTE Direktive (99/5/EC). **Italiano:** Il prodotto soddisfa i requisiti della Direttiva R&TTE (99/5/EC). **Magyar:** Teljesítjük az R&TTE irányelv (99/5/EC) követelményeit. **Nederlands:** We voldoen aan de vereisten die in de R&TTE-richtlijn (99/5/EG) worden gesteld. **Norsk:** Vi oppfyller kravene i R&TTE-direktivet (99/5/EC). **Polski:** Spełniamy wymagania dyrektywy R&TTE (99/5/WE). **Português:** São cumpridos os requisitos da Directiva R&TTE (99/5/EC). PB Attendemos aos requisitos da Diretriz R&TTE (99/5/EC). **Română:** Îndeplinim cerințele directivei R&TTE (99/5/EC). **Slovenčina:** Výrobok spĺňa požiadavky smernice R&TTE (99/5/EC). **Suomi:** Täytämme radio- ja telepäätelaitedirektiivin (99/5/EY) asettamat vaatimukset. **Svenska:** Vi uppfyller kraven i R&TTE-direktivet (99/5/EC). **Ελληνικά:** Πληρούμε τις απαιτήσεις της Οδηγίας R&TTE (99/5/EK).



www.yoyomotion.com